

# Route 320

Effective Date  
June 13, 2011

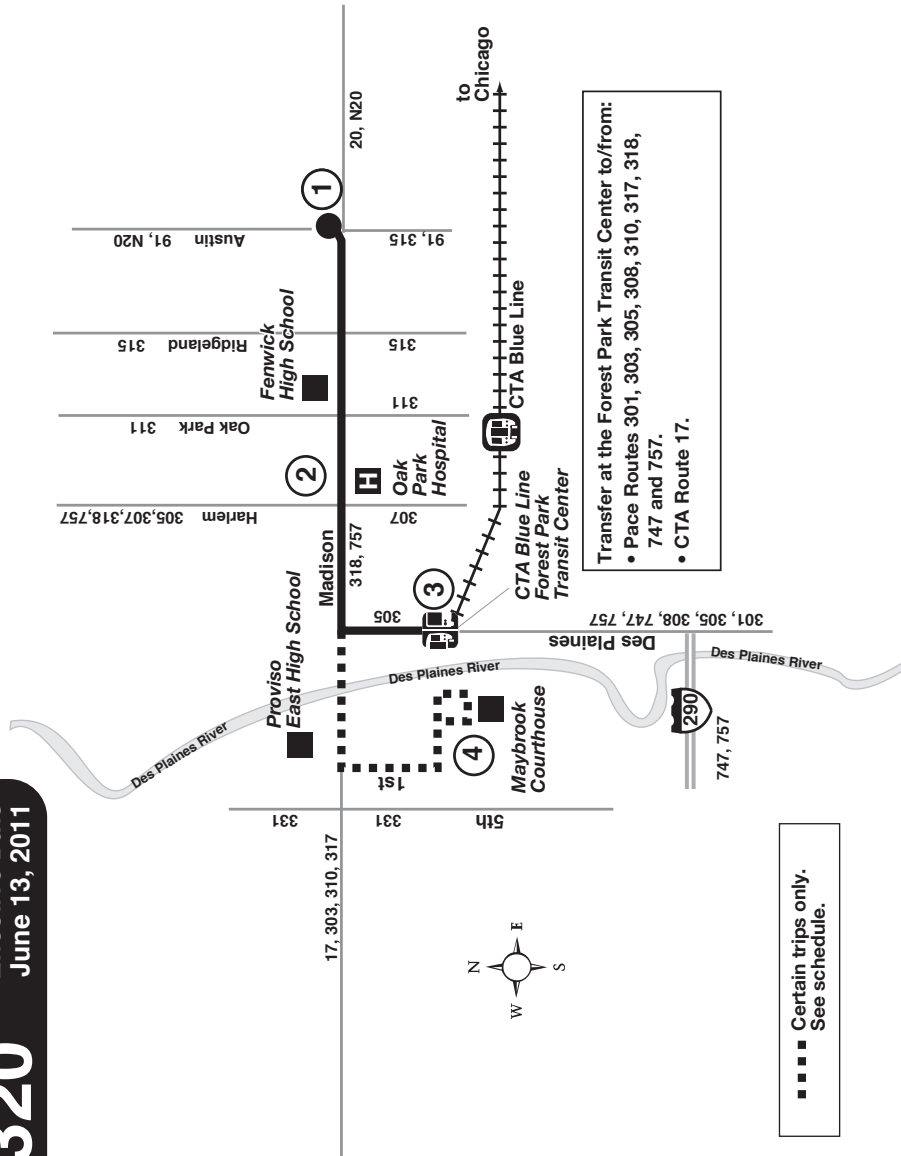

Transfer at the Forest Park Transit Center to/from:

- Pace Routes 301, 303, 305, 308, 310, 317, 318, 747 and 757.
- CTA Route 17.

■ ■ ■ ■ ■ Certain trips only.  
See schedule.

051210rp030211rev

## REGULAR FARE ROUTE

**Exact Fare Required  
Driver Has No Change**

Please refer to the Pace Fare Guide for details about current fares, passes, tickets, reduced fares, restrictions and additional information. Pace has a variety of passes and tickets that can make traveling on Pace, CTA and Metra easier and more cost effective. Call (847) 364-7223 or visit [www.pacebus.com](http://www.pacebus.com) for details. Reduced Fares are available for children (ages 7-11), students traveling to and from school, and persons with disabilities. A Medicare card along with another source of identification with a photograph and date of birth is acceptable to obtain the RTA Reduced Fare Card/Permit. The RTA Reduced Fare Permit is required for persons with disabilities. Free rides are offered to area residents age 65 and older (with a Senior Reduced Fare Card or Senior Ride Free Smart Card), children under 7, and active duty military personnel in uniform. Persons with disabilities (who are enrolled in the Illinois Circuit Breaker Program) may ride Pace fixed route service free of charge with the Circuit Permit. To register for a permit/card, please contact the RTA at 836-7000.

### TRAVEL INFORMATION

If you need transit information please call:  
**The RTA Travel Information Center**, open daily from 5:00 a.m. to 1:00 a.m. Use from all suburban area codes. **836-7000**  
**TTY# (For HEARING IMPAIRED ONLY)**  
**(312) 836-4949**  
**Pace Customer Relations**, Monday through Friday from 8:00 a.m. to 5:00 p.m.  
**(847) 364-PACE (7223)**  
**TTY# (Pace information for HEARING IMPAIRED ONLY)** **(847) 364-5093**

### CARRIER INFORMATION

**OPERATED BY: Pace West**  
**For lost and found call (708) 344-7400**

### ADDITIONAL INFORMATION

The schedules, fares and other information in this timetable are subject to change. Pace does not assume responsibility for errors in timetables, nor for inconvenience or damage resulting from delayed trains or buses or failure to make connections.

Unless otherwise noted, bus will stop upon signal to driver at any intersection along the route where it is safe to do so.

# 320 Madison Street

All Pace service is wheelchair accessible.



All Pace buses are equipped with bike racks.

## Major Destinations

Fenwick High School

Oak Park Hospital

CTA Blue Line Forest Park Transit Center

Proviso East High School

Maybrook Courthouse

*Weekday Rush Hour Service*

# June 13, 2011

[www.pacebus.com](http://www.pacebus.com)